

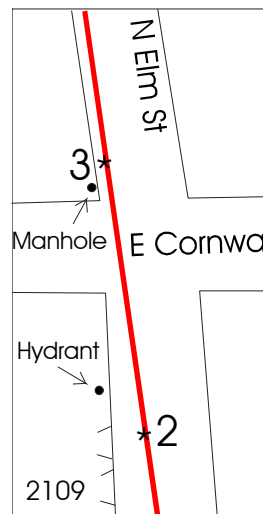

City Stage Greensboro NC-0000

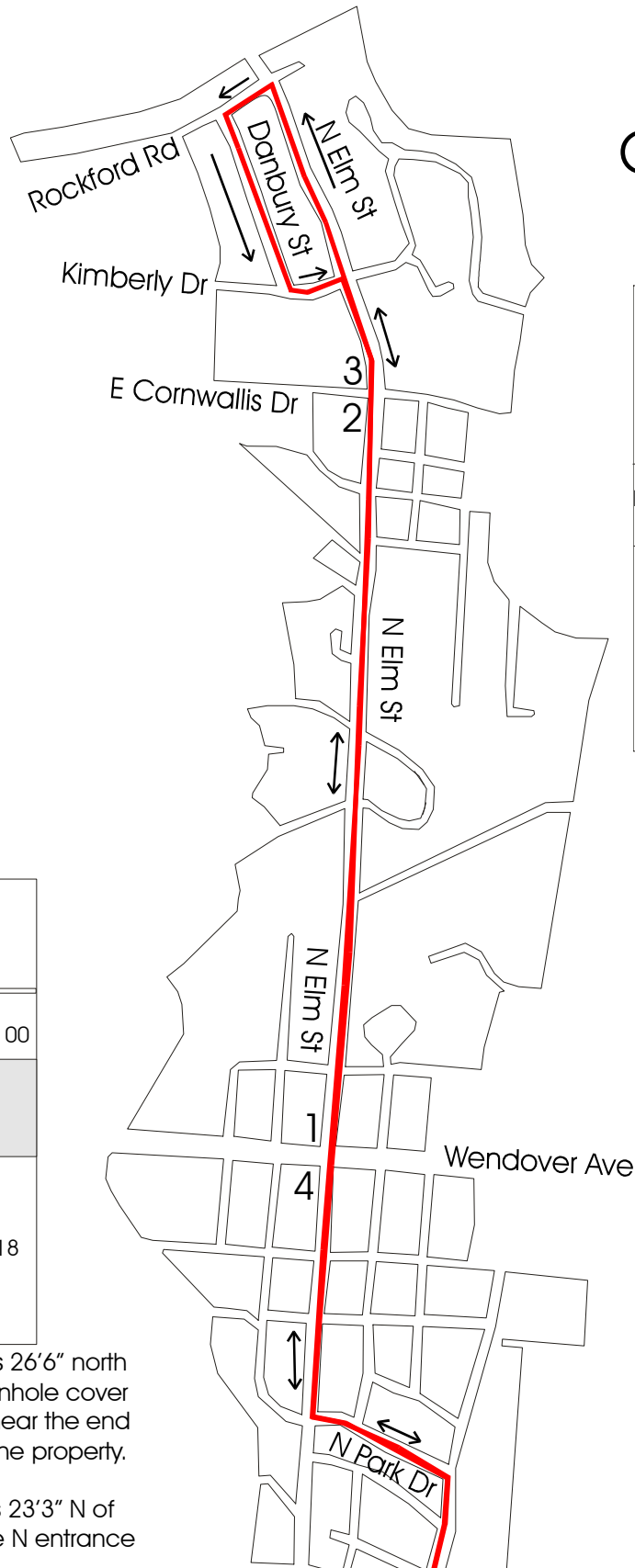

The two mile marker of the hydrant N of the to 2109 N Elm.

The three mile marker of the center of the road the NW corner of N E

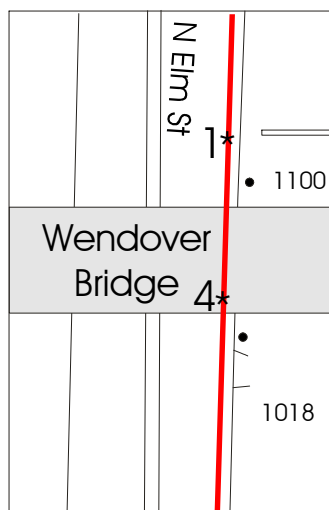

The one mile marker lies 26'6" north of the center of the manhole cover in front on 1100 N Elm near the end of a wall at the end of the property.

The four mile marker lies 23'3" N of the manhole next to the N entrance to 1018 N Elm St

The start lies E Lindsay and the PTD account

The finish lies at the end of

